

Loft House

ASHLEY DOWN

APPROXIMATE FLOOR AREA
69.9 SQM / 753 SQFT

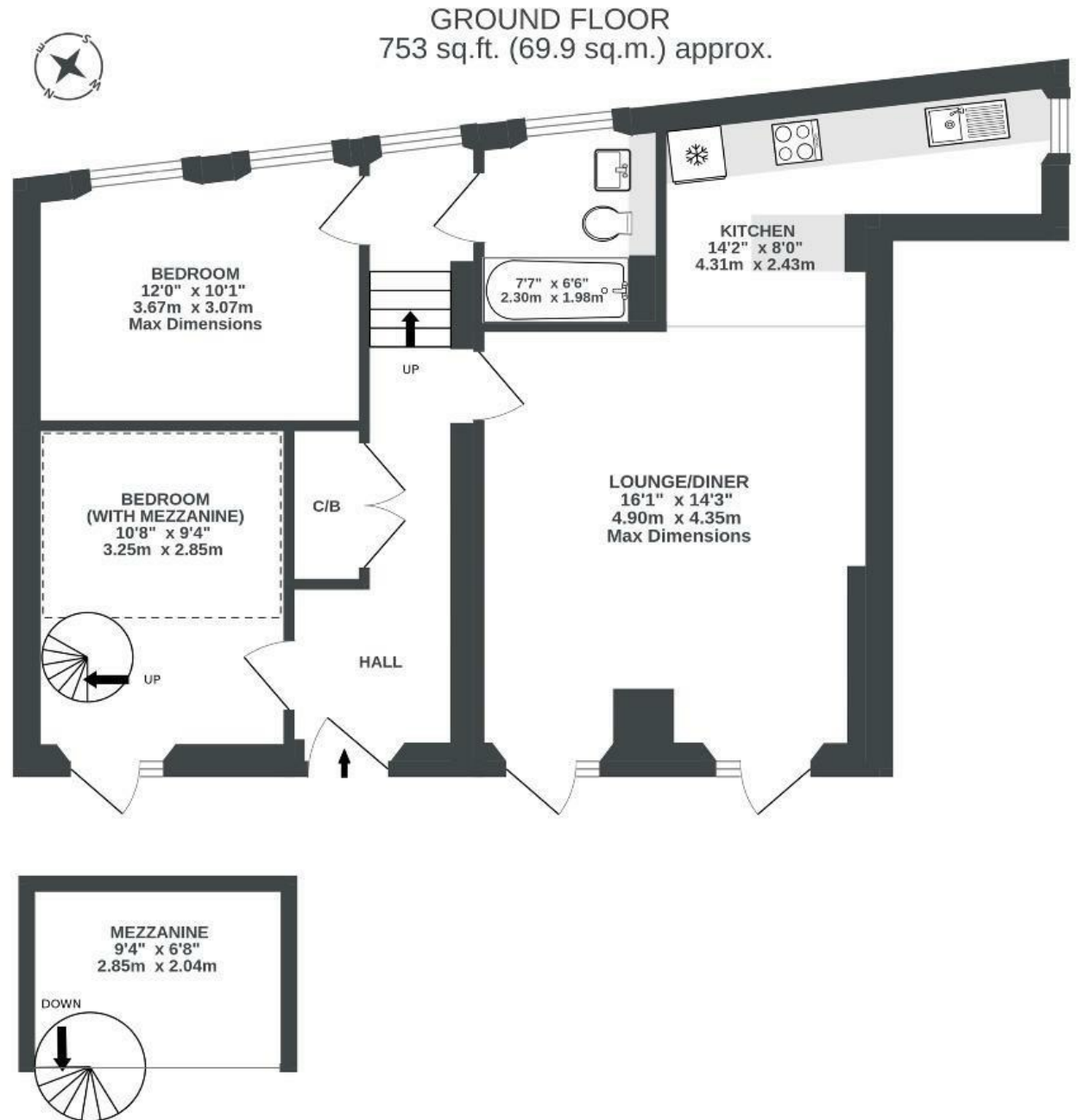

Illustrations are for reference purposes only, measurements are approximate, not to scale.

Boardwalk

College Road

BISHOPSTON, BRISTOL



£350,000



2 Bedrooms



Bristol, BS7



1 Bathrooms

9FG

"The property is so peaceful with it's own private access and large patio looking onto the secure courtyard garden. Alongside the tranquillity, you have all the benefits of living in vibrant BS7 including Gloucester Road's bars and cafes, St Werburghs City Farm, Purdown & St Andrews Park for walks and great coffee.

One of the things we love about the property is that there is lots of space afforded by the high ceilings and open living area yet it has always felt cosy and homely. There is a real sense of community and safety here at Loft House and we have certainly made friends for life here.

We have poured a lot of love into the flat and hope it goes to someone who is going to be as happy here as we have been."

